

2024 OFMA Layout and guide lines for the Convention January 4-7, 2024

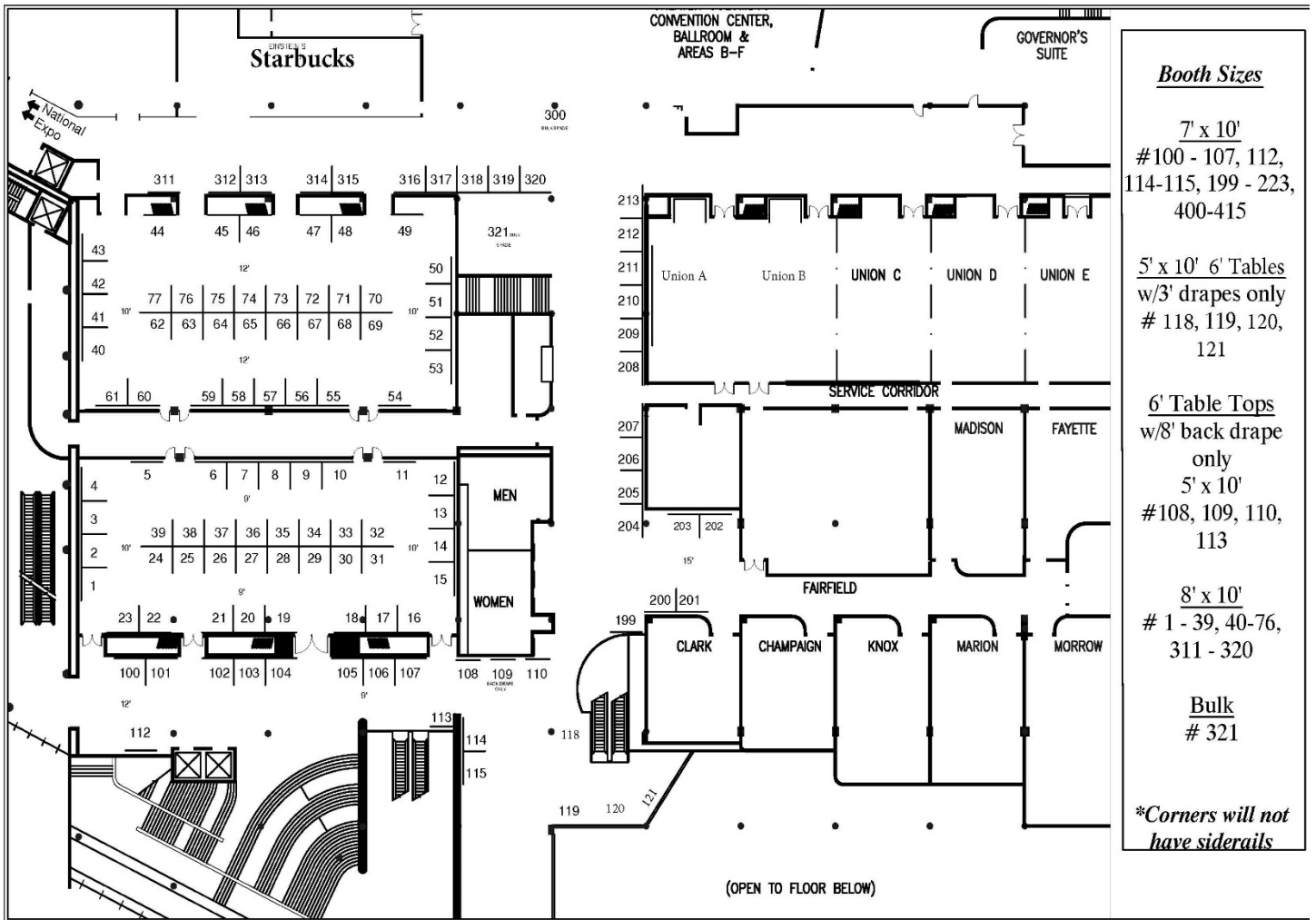

NATIONAL EXPO SHOW NAME: Ohio Fair Managers Association Annual Convention
 SHOW FACILITY: Hyatt Regency - Halls Franklin - Delaware Rooms - Lobby

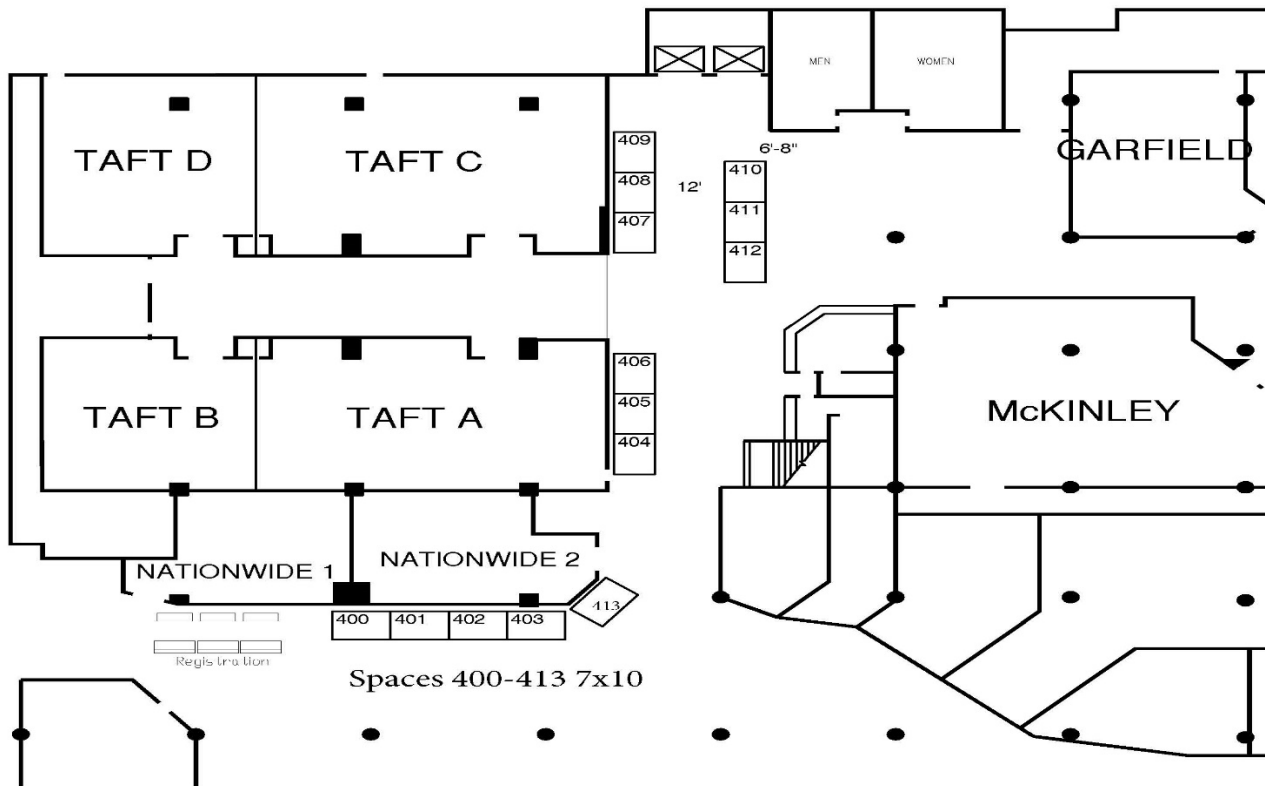

SHOW NAME: Ohio Fair Managers Association Annual Convention
 SHOW FACILITY: Hyatt Regency - First Floor Lobby

The OFMA TRADE SHOW provides a unique opportunity for exposure and contact with approximately 2000+ decision makers from Ohio's 95 fairs, with representatives of many Ohio's Festivals as well as about 700 concessionaires.

EXHIBIT HOURS: Friday, 10 a.m. - 5:15 p.m. and Saturday, 10 a.m. – 5:15 p.m.

SET UP HOURS: Bulk Exhibits – Thursday, 10 – 5 p.m.
Booth Exhibits – Thursday, 1 –7 p.m.

TEAR DOWN HOURS: Saturday, 5:30 p.m. – 10 p.m.

- Space Assignment will be 1st requested – 1st assigned (by postmarks), except those with advanced deposits.
- Unless otherwise requested, each booth will include a 6' skirted table, two chairs, and back and side drapes. The double booth will be equipped with one additional 6' skirted table.

REFUND POLICY: Cancellation by December 1st - 66% refund
Cancellation by December 10th - 33% refund
Cancellation after December 10th - 0% refund

****CHECKS MUST BE MADE PAYABLE TO THE OHIO FAIR MANAGERS ASSOCIATION. MAIL PAYMENT, THE ATTACHED CONTRACT AND THE MEMBERSHIP/REGISTRATION FORM TO: OFMA, P.O. BOX 2625, STOW, OH 44224.**

*All exhibitors **MUST BE** a current Associate Member of the Ohio Fair Managers Association.

*Bulk exhibits may be set up between 10:00 – 5:00 p.m. on Thursday. Booth exhibits can be set up between 1:00 – 7:00 p.m. All exhibits must be in place by 7:00 p.m. Thursday evening.

*Exhibitors setting up booths only, may not drive vehicles into the exhibit hall. All materials must be handled by hand, etc. Tow motors also may not be used.

*Beginning at 5:00 p.m. on Thursday, 24-hour uniform security will be provided within the Trade Show Exhibit Area. Security will be around the clock until 5:15 p.m. Saturday.

*Exhibits should be removed no earlier than 5:15 p.m. Saturday. Failure to comply with the show hours may subject the exhibitor to a one-year probation. This is for your company benefit as well as those around you. We hold drawings in different areas to get attendees to move to different spots within the tradeshow to help your business, so please help us by remaining in your booth until the tradeshow closes at 5:15 pm on Sat.

There is no provision for onsite storage of exhibit material before, during or after the show.

*For additional information, Call the OFMA office at 330-208-0372 or e-mail us at ohiofairs@att.net.